

Phase III Unit Site Plans

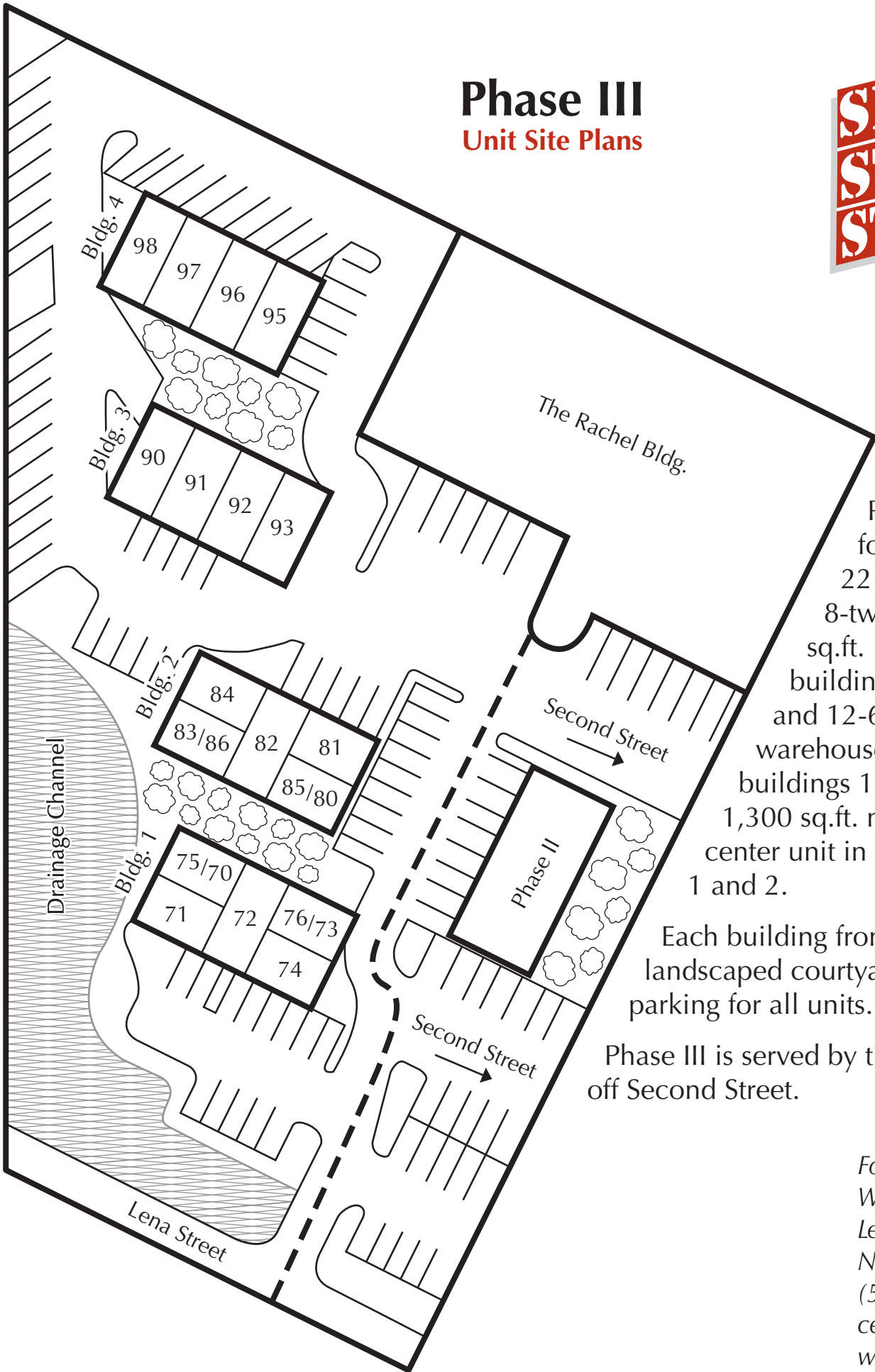

Phase III contains four buildings with 22 units. There are 8-two story 1,300 sq.ft. live/work units in buildings 3 and 4 and 12-600 sq.ft. office/warehouse/studio units in buildings 1 and 2, plus a 1,300 sq.ft. non-residential center unit in both buildings 1 and 2.

Each building fronts onto a landscaped courtyard with adequate parking for all units.

Phase III is served by three drives off Second Street.

For information call
Wayne D. Nichols
Leasing Agent
Nichols Agency
(505) 984-3000
cell (505) 699-7280
wdnichols@aol.com

SANTA FE'S PIONEERING LIVE / WORK COMMUNITY